

Recommended P.C.B Layout(Top Side)
(PCB BOARD TOLERANCE±0.05)

SPECIFICATIONS

Rated Current:3.0AMP
 Contact Resistance:20mΩ Max
 Withstand Voltage:1000V AC/DC
 Insulation Resistance:1000MΩ Min
 Operation Temperature:-40°C to +105°C

Contact Material:Brass
 Contact Plating:Au or Sn Over Ni
 Insulator Material:Polyester(UL94V-0)
 Standard: PBT
 Max.Processing Temp: 180°C for 30-60 seconds
 (200°C for 10 seconds)

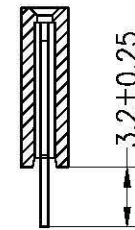
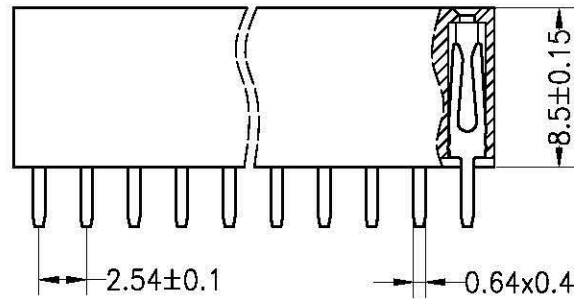
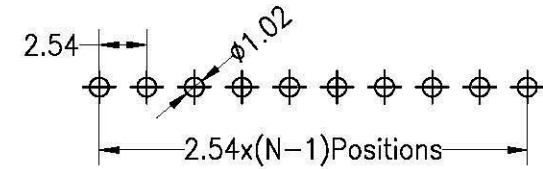
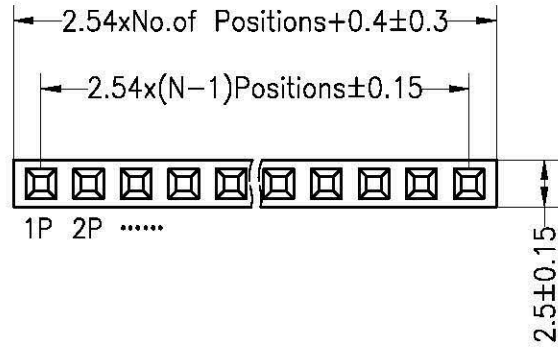

				OPERATION		DRAW	YiYuSheng	12.03.28	SCALE	FIT		
				X.X	±0.30				UNIT	mm		
				X.XX	±0.20	CHECK			SIZE	A4	PART NO.	
				X.XXX	±0.10					SHEET	1/1	FH-1x_ _SG/RH
A0	2012.03.28	NEW DRAWING		Angle	±3°	APPROVE			PROJ.	◆ ▽	TITLE:	
REV	DATE	MODIFICATION DESCRIPTION		DIM	TOL							2.54PF H8.5mm 1xNpin 180° W2.5mm